

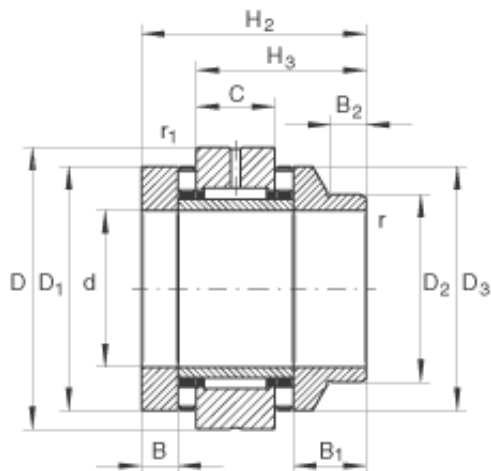

BEARING-MALAYSIA SDN.BHD.



55 mm x 115 mm x 17,5 mm INA ZARN55115-L-TV Complex bearing

Bearing No. ZARN55115-L-TV

Size	55x115x103 mm
Bore Diameter	55 mm
Outer Diameter	115 mm
Width	103 mm
d	55 mm
D	115 mm
H ₂	103 mm
B	17,5 mm
B ₁	38,5 mm
B ₂	14 mm
C	25 mm
D ₁	100 mm
D ₂	80 mm
D ₃	98 mm
D _{a max}	101 mm
d _{a min}	78 mm
H ₃	74,5 mm
r _{1 min}	0,6 mm
r _{min}	0,3 mm
m	4 kg / Weight
C _a	177000 N / Dynamic load rating (axial)
C _{0a}	500000 N / Static load rating (axial)

ZARN55115-L-TV Bearing 2D drawings and 3D CAD models



BEARING-MALAYSIA SDN.BHD.

C_r	44000 N / Dynamic load rating (radial)
C_{0r}	98000 N / Static load rating (radial)
$n_{G\ OI}$	2900 1/min / Limiting speed for oil lubrication (valid only with adequate oil cooling)
$n_{G\ Fett}$	1000 1/min / Limiting speed for grease lubrication
M_{RL}	4 Nm / Bearing frictional torque
C_{aL}	4900 N/ μ m / Axial rigidity
C_{kL}	3600 Nm/mrad / Tilting rigidity
M_m	43 kg x cm ² / Mass moment of inertia for rotating inner ring
	1 μ m / Axial runout (The axial runout data for screw drive bearing arrangements are based on the rotating inner ring)
	ZMA55/98 / Designation of recommended INA locknut
Category	Ball Bearings
Inventory	0.0
Manufacturer Name	SCHAEFFLER GROUP
Minimum Buy Quantity	N/A
Weight / Kilogram	4
EAN	4012802078459
Product Group	B00234