

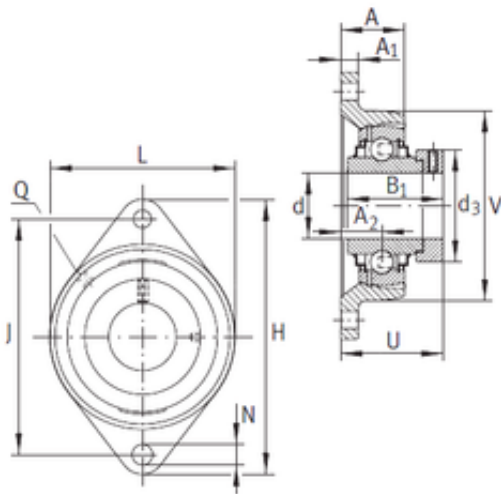

BEARING-MALAYSIA SDN.BHD.

INA LCJT45 Bearing unit



LCJT45 Bearing 2D drawings and 3D CAD models

Bearing No. LCJT45

Bore Diameter	45 mm
d	45 mm
V	111 mm
U	59,1 mm
Thread (Q)	Rp1/8
d3	63 mm
A	35 mm
A1	13 mm
B1	56,5 mm
H	180 mm
J	148,5 mm
L	111 mm
N	14 mm
A2	24 mm
Weight	1,81 Kg
Basic dynamic load rating (C)	32,5 kN
Category	Flange Block Bearings
Inventory	0.0
Manufacturer Name	SCHAEFFLER GROUP
Minimum Buy Quantity	N/A
Weight / Kilogram	2.634
EAN	4012802798098
Product Group	M06110
Number of Mounting Holes	2
Mounting Method	Eccentric Collar
Housing Style	2 Bolt Flange Block



BEARING-MALAYSIA SDN.BHD.

Rolling Element	Ball Bearing
Housing Material	Cast Iron
Expansion / Non-expansion	Non-expansion
Mounting Bolts	14 Millimeter
Relubricatable	Yes
Insert Part Number	GE45-KLLHB
Seals	Double Labyrinth
Housing Configuration	1 Piece Solid
Pilot Configuration	No Pilot
Inch - Metric	Metric
Long Description	2 Bolt Flange Block; 45MM Bore; 148MM Bolt Circle; 148.5MM Bolt Spacing; 1 Piece Solid; Eccentric Collar Mount; Cast Iron; Ball Bearing; 56.3MM Length Thru Bore; Relubricatable; Double Labyrinth Seals
Other Features	Single Row With Set Screw
Category	Flange Block
UNSPSC	31171501
Harmonized Tariff Code	8483.20.40.40
Noun	Bearing
Keyword String	Flanged
Manufacturer URL	http://www.ina.com
Manufacturer Item Number	LCJT45
Weight / LBS	4.631
Nominal Bolt Circle Diameter Round	5.8 Inch 148 Millimeter
Bore	1.772 Inch 45 Millimeter
Length Thru Bore	2.217 Inch 56.3 Millimeter
Cartridge Pilot Diameter	0 Inch 0 Millimeter
Cartridge Pilot Depth	0 Inch 0 Millimeter
Bolt Spacing	5.846 Inch 148.5 Millimeter



BEARING-MALAYSIA SDN.BHD.